

Planetary Small Geared Motor PE with DC Motor, Size 1

Housing: Steel, zinc-plated, sealed against lubricant leaks and protected against dust, can be mounted in any position.
Gearbox: 1st gear stage: plastic gears, other gears made from steel.
Bearing: Motor roller bearing. Gearbox: sintered bronze plain bearing.
Lubrication: Maintenance free grease lubrication.
Motor: Brushed DC motor 24 V.
 Nominal motor speed 6,000 min⁻¹.
 Pinion milled into motor shaft. Free lead ends.
 Sense of rotation can be changed by swapping leads over.
 Protection class: IP 21.
 Insulation class: E.
 Operating mode: S1.

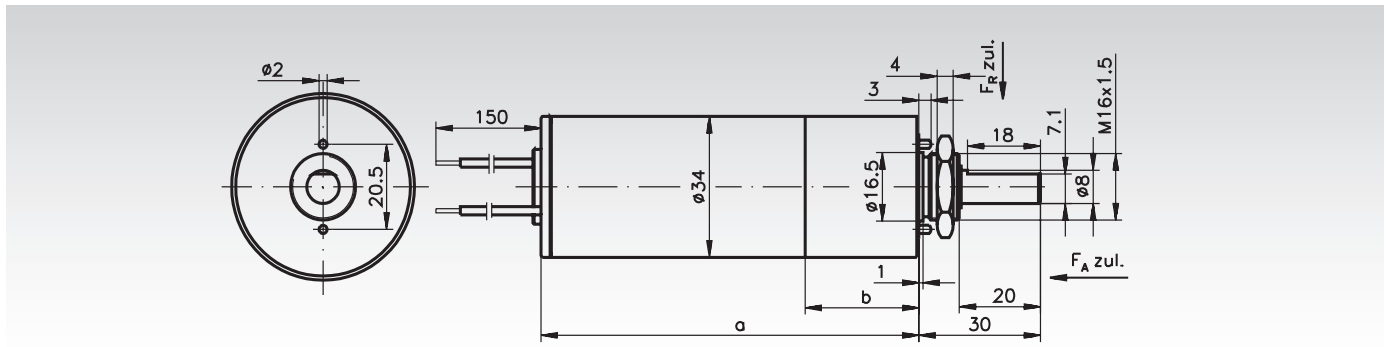

Ordering Details: e.g.: Type, Size 1, Voltage, Output Speed, Product No.



Size 1

Product No. 24 V	Nominal Output Speed min ⁻¹	Ratio i	max. continous Torque Nm	max. Starting Torque Nm	Nominal Motor Power W	Output Power W	Gearbox Efficiency %	a mm	b mm	Weight kg
430 440 24	200	30:1	0,46	0,6	12	9,6	80	141	27	0,55
430 441 24	67	90:1	1,20	1,8	12	8,4	70	148	34	0,6
430 442 24	50	120:1	1,60	2,2	12	8,4	70	148	34	0,6
430 443 24	29	210:1	2,80	3,3	12	8,4	70	148	34	0,6
430 444 24	22	270:1	2,90	3,3	10	6,7	65	155	41	0,65

Permissible radial shaft load F_R : 30 N (middle shaft).

Permissible axial shaft load F_A : 0 N.

Tolerances +/- 10%.

Note

The efficiency stated in the table is valid for properly run-in gearboxes at operating temperature. To prevent the gearbox from being overloaded, the stated limit loads must not be exceeded. At reversed operation the limit loads must be multiplied with the factor 0.75.

Also available as an option with 12 V motors and larger gear ratio up to 54880:1.