

Heavy-Duty Rod Ends BR-R with Spherical Bearing DIN ISO 12240-4 Series K, Stainless Steel, Internal Thread

Material rod end: Stainless steel, forged, hardened.
Bearing race superfinished.



Material inner ring and rollers: Stainless steel, hardened, superfinished.

Lubricant: Aluminium-complex-soap-grease, approval according to NSF H1, -45°C to +120°C. Special grease if required.

Basically without friction, long-term lubrication, sealed with cover plates, offer small dimensions, large pivoting angle and high load rating.

IR = Internal Right-hand thread. **IL** = Internal Left-hand thread.

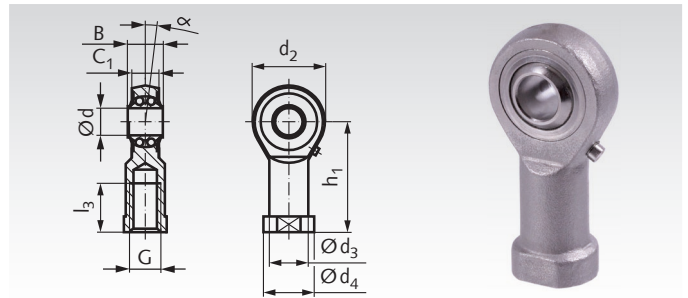

Ordering Details: e.g.: Product No. 632 994 06, Rod End BR-R, IR

| Product No. IR | Product No. IL | d ^{H7} mm | B ^{-0.1} mm | C ₁ mm | d ₂ mm | d ₃ mm | d ₄ mm | h ₁ mm | l ₃ mm | G mm | α ° | Load Rating [kN] | | Calculation Factors* | | Speed n _{max} min ⁻¹ | Weight g |
|-------------------|-------------------|-----------------------|-------------------------|----------------------|----------------------|----------------------|----------------------|----------------------|----------------------|---------|--------|------------------|--------------------------|----------------------|----------------|--|-------------|
| | | | | | | | | | | | | dynam. C | static C ₀ | Y | Y ₀ | | |
| 632 994 06 | 632 994 56 | 6 | 9 | 6,75 | 20 | 10 | 13 | 30 | 12 | M6 | 8 | 1,9 | 0,5 | 2,09 | 2,19 | 1350 | 24 |
| 632 994 08 | 632 994 58 | 8 | 12 | 9 | 24 | 12,5 | 16 | 36 | 16 | M8 | 8,5 | 2,8 | 0,7 | 1,8 | 1,89 | 1300 | 44 |
| 632 994 10 | 632 994 60 | 10 | 14 | 10,5 | 28 | 15 | 19 | 43 | 20 | M10 | 8 | 3,1 | 1,0 | 1,9 | 1,81 | 1225 | 72 |
| 632 994 12 | 632 994 62 | 12 | 16 | 12 | 32 | 17,5 | 22 | 50 | 22 | M12 | 7,5 | 3,5 | 1,3 | 1,74 | 1,82 | 1125 | 107 |
| 632 994 16 | 632 994 66 | 16 | 21 | 15 | 42 | 22 | 27 | 64 | 28 | M16 | 8 | 4,3 | 1,6 | 2,24 | 2,35 | 975 | 224 |
| 632 994 20 | 632 994 70 | 20 | 25 | 18 | 50 | 27,5 | 34 | 77 | 33 | M20x1,5 | 7 | 5,4 | 2,3 | 2,46 | 2,58 | 825 | 367 |

* Calculation see page 645.

Heavy-Duty Rod Ends BR with Spherical Bearing DIN ISO 12240-4 Series K, Stainless Steel, External Thread

Material rod end: Stainless steel, forged, hardened.
Bearing race superfinished, thread rolled.



Material inner ring and rollers: Stainless steel, hardened, superfinished

Lubricant: Aluminium-complex-soap-grease, approval according to NSF H1, -45°C to +120°C. Special grease if required.

Basically without friction, long-term lubrication, sealed with cover plates, offer small dimensions, large pivoting angle and high load rating.

AR = External Right-hand thread. **AL** = External Left-hand thread.

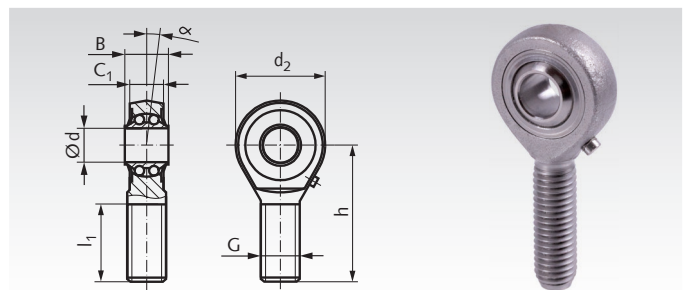

Ordering Details: e.g.: Product No. 632 995 06, Rod End BR-R, AR

| Product No. AR | Product No. AL | d ^{H7} mm | B ^{-0.1} mm | C ₁ mm | d ₂ mm | h mm | l ₁ mm | G mm | α ° | Load Rating [kN] | | Calculation Factors* | | Speed n _{max} min ⁻¹ | Weight g |
|-------------------|-------------------|-----------------------|-------------------------|----------------------|----------------------|---------|----------------------|---------|--------|------------------|--------------------------|----------------------|----------------|--|-------------|
| | | | | | | | | | | dynam. C | static C ₀ | Y | Y ₀ | | |
| 632 995 08 | 632 995 58 | 8 | 12 | 9 | 24 | 42 | 25 | M8 | 8,5 | 2,8 | 0,7 | 1,8 | 1,89 | 1300 | 36 |
| 632 995 10 | 632 995 60 | 10 | 14 | 10,5 | 28 | 48 | 29 | M10 | 8 | 3,1 | 1,0 | 1,9 | 1,81 | 1225 | 60 |
| 632 995 12 | 632 995 62 | 12 | 16 | 12 | 32 | 54 | 33 | M12 | 7,5 | 3,5 | 1,3 | 1,74 | 1,82 | 1125 | 87 |
| 632 995 16 | 632 995 66 | 16 | 21 | 15 | 42 | 66 | 40 | M16 | 8 | 4,3 | 1,6 | 2,24 | 2,35 | 975 | 190 |
| 632 995 20 | 632 995 70 | 20 | 25 | 18 | 50 | 78 | 47 | M20x1,5 | 7 | 5,4 | 2,3 | 2,46 | 2,58 | 825 | 338 |

* Calculation see page 645.

Threaded bars with metric thread and Fine thread page 556.
Loctite thread locking and bonding products page 849.