

## Linear Bearings KB-3 ISO Series 3, Easy-Line, Closed Design

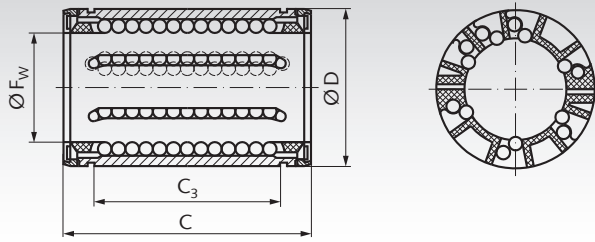

Linear bearings from reliable brand in good quality. Our Easy-Line bushes with swimming seals are very light running.

These linear bearings can be fitted inside a customer's housing or as spare parts for our closed Easy-Line units.

These bearings are self-aligning up to +/- 0,5°.

All bearings must be lubricated before use.

Recommended shaft tolerance h6, housing tolerance H6.

With wiping seals.

Ordering Details: e.g.: Product No. 646 112 02, Linear Bearing KB-3, Easy-Line, Internal Ø 12 mm

Product No. Closed	F <sub>w</sub> mm	D mm	C <sup>-0,02</sup> mm	C <sub>3</sub> <sup>-0,02</sup> mm	Load rating dyn. C N	Load rating stat. C <sub>0</sub> N	Weight g	Product No.	Weight
								Retaining Ring DIN 471 Page 582	g
646 112 02	12	22	32	20,3	1020	1290	16	617 422 00	1,7
646 116 02	16	26	36	22,3	1250	1550	21	617 426 00	2,1
646 120 02	20	32	45	28,3	2090	2630	43	617 432 00	3,6
646 125 02	25	40	58	40,4	3780	4720	85	617 440 00	6,3
646 130 02	30	47	68	48,4	5470	6810	130	617 447 00	7,8
646 140 02	40	62	80	56,3	6590	8230	260	617 462 00	14,4
646 150 02	50	75	100	72,3	10800	13500	460	617 475 00	21,0

Shaft steel page 466. Shaft blocks page 475.  
Precision housings page 481.

## Linear Bearings KB-3-O ISO Series 3, Easy-Line, Open Design

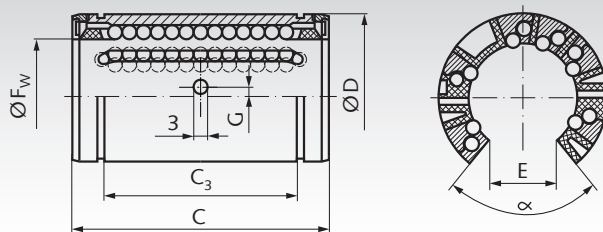

Linear bearings from reliable brand in good quality. Our Easy-Line bushes with swimming seals are very light running.

These linear bearings can be fitted inside a customer's housing or as spare parts for our open Easy-Line units.

These bearings are self-aligning up to +/- 0,5°.

All bearings must be lubricated before use.

Recommended shaft tolerance h6, housing tolerance H6.

With wiping seals.

Ordering Details: e.g.: Product No. 646 112 03, Linear Bearing KB-3-O, Easy-Line, Open Design, Internal Ø 12 mm

Product No.	F <sub>w</sub> mm	D mm	C mm	C <sub>3</sub> mm	G mm	E mm	α °	Load rating		Weight g
								dyn. C N	stat. C <sub>0</sub> N	
646 112 03	12	22	32	20,3	0	6,5	66	1020	1290	13
646 116 03	16	26	36	22,3	0	9,0	68	1250	1550	17
646 120 03	20	32	45	28,3	0	9,0	55	2090	2630	36
646 125 03	25	40	58	40,4	1,5 <sup>1)</sup>	11,5	57	3780	4720	71
646 130 03	30	47	68	48,4	2,0	14,0	57	5470	6810	114
646 140 03	40	62	80	56,3	1,5	19,5	56	6590	8230	230
646 150 03	50	75	100	72,3	2,5	22,5	54	10800	13500	390

<sup>1)</sup> At size 25 the fixing hole Ø 3 mm is located below the middle.

Shaft steel with shaft support page 467.  
Precision housings page 481.